



The Oaklands

Middleton One Row DL2 1BD

£295,000





This footer paragraph is an example only and should not be relied upon as complying with current legislation. These particulars, whilst believed to be accurate are set out as a general outline only for guidance and do not constitute any part of an offer or contract. Intending purchasers should not rely on them as statements of representation of fact, but must satisfy themselves by inspection or otherwise as to their accuracy. No person in this firm's employment has the authority to make or give any representation or warranty in respect of the property.



This footer paragraph is an example only and should not be relied upon as complying with current legislation. These particulars, whilst believed to be accurate are set out as a general outline only for guidance and do not constitute any part of an offer or contract. Intending purchasers should not rely on them as statements of representation of fact, but must satisfy themselves by inspection or otherwise as to their accuracy. No person in this firms employment has the authority to make or give any representation or warranty in respect of the property.



This footer paragraph is an example only and should not be relied upon as complying with current legislation. These particulars, whilst believed to be accurate are set out as a general outline only for guidance and do not constitute any part of an offer or contract. Intending purchasers should not rely on them as statements of representation of fact, but must satisfy themselves by inspection or otherwise as to their accuracy. No person in this firm's employment has the authority to make or give any representation or warranty in respect of the property.



This footer paragraph is an example only and should not be relied upon as complying with current legislation. These particulars, whilst believed to be accurate are set out as a general outline only for guidance and do not constitute any part of an offer or contract. Intending purchasers should not rely on them as statements of representation of fact, but must satisfy themselves by inspection or otherwise as to their accuracy. No person in this firm's employment has the authority to make or give any representation or warranty in respect of the property.

The Oaklands

Middleton One Row DL2 1BD



- Two Bedroom Semi-Detached Bungalow
- Summerhouse/Office and Greenhouse
- EPC Rating C

- Sought After Middleton One Row Village Location
- Modern Interior
- Viewing Recommended

- Off Street Parking, Garage And Open Views To Rear
- Council Tax Band C
- Village Life Location Close To Amenities

Situated within the highly sought-after village of Middleton One Row, N/r Darlington, this immaculately presented semi-detached bungalow offers a superb standard of accommodation, perfectly suited to those seeking a refined yet relaxed lifestyle.

Boasting two generous reception rooms and two well-appointed bedrooms, the property provides both comfort and versatility, ideal for modern living. Occupying a substantial west-facing corner plot, the bungalow enjoys attractive open views across surrounding fields, creating a wonderfully peaceful setting to be enjoyed throughout the day and into the evening.

The beautifully maintained gardens further enhance the appeal, offering a private and inviting space for outdoor relaxation and entertaining. The garden room/sun room provides a seamless transition to the outdoors, opening directly onto the rear patio—perfect for enjoying the surroundings in warmer months. A particular highlight is the exceptional summerhouse, currently utilised as an art studio. Finished to a high standard with underfloor heating, internet, insulation, and full double glazing, it provides a highly versatile, year-round space—ideal as a creative studio, home gym, or tranquil workspace.

The property also benefits from a garage equipped with power and lighting, along with ample off-street parking for two vehicles, ensuring both convenience and practicality. South facing solar panels further complement the home, reflecting a thoughtful approach to energy efficiency and modern living.

Middleton One Row is a picturesque and well-regarded village, known for its scenic surroundings and strong sense of community. The presence of a popular pub, restaurant, and hotel adds to the lifestyle appeal, offering excellent options for dining and socialising within easy reach. The location also provides convenient access to nearby towns and transport links, making it an ideal balance of countryside living and everyday accessibility.

Entrance Porch

Composite door to front and laminate flooring, space for coat and shoe storage.

Lounge

15'07 x 14'04 (4.75m x 4.37m)

Upvc double glazed window to front, coving to ceiling, fireplace with inset electric fire and radiator.

Kitchen

10'05 x 8'11 (3.18m x 2.72m)

Upvc double glazed window to rear, fitted with wall, base and drawer unit, sink with mixer tap. Four ring gas hob with extractor over and oven. Space for a washing machine, dishwasher and fridge freezer. Wall mounted Baxi boiler.

Dining Area

Open plan to conservatory, radiator and laminate flooring. Door leading into the integral garage.

Garden/Sun Room

15'11 x 9'09 (4.85m x 2.97m)

A lovely spacious garden room enjoying the garden views with triple-glazed windows and double doors to rear, two radiators and spotlights to ceiling.

Bedroom One

19'01 x 8'11 (5.82m x 2.72m)

Upvc double glazed window to front and radiator.

Bedroom Two

10'05 x 8'11 (3.18m x 2.72m)

Upvc double glazed window to rear and radiator.

Bathroom

Comprising panelled bath, low level w.c and wash hand basin, heated towel rail, tiled walls and floor with access to large loft space.

Externally

The front of the property is lawned with driveway for off street parking, there is also an attractive side garden with seasonal plants and flowers.

The rear enclosed garden is mainly laid to lawn with Yorkshire stone patio area, well planned and stocked borders including a number of fruit trees, shed, Elton Greenhouse (10'x8) leading to the Summerhouse.

Summerhouse

20'11 x 10'05 (6.38m x 3.18m)

With double doors, beams to ceiling, concrete floor base and insulated roof and walls. Thermal blinds and under floor heating. Lighting with sensors, separate fuse box and internet connection in place.

Garage

22'0 x 7'11 (6.71m x 2.41m)

With up and over door, also accessible from the house with power and light.

Tenure

Freehold

Property Details

Local Authority: Darlington

Council Tax Band: C

Annual Price: £2,108

Conservation Area No

Flood Risk Very low

Floor Area 1,323 ft 2 / 123 m 2

Plot size 0.14 acres (2 Plots)

Mobile coverage

EE

Vodafone

Three

O2

Broadband

Basic

28 Mbps

Ultrafast

1000 Mbps

Satellite / Fibre TV Availability

BT

Sky

Virgin

Note

IMPORTANT NOTE TO PURCHASERS: We endeavour to make our sales particulars accurate and reliable, however, they do not constitute or form part of an offer or any contract and none is to be relied upon as statements of representation or fact. The services, systems and appliances listed in this specification have not been tested by us and no guarantee as to their operating ability or efficiency is given. All measurements have been taken as a guide to prospective buyers only, and are not precise. Floor plans where included are not to scale and accuracy is not guaranteed. If you require clarification or further information on any points, please contact us, especially if you are travelling some distance to view. Fixtures and fittings other than those mentioned are to be agreed with the seller. We cannot also confirm at this stage of marketing the tenure of this house

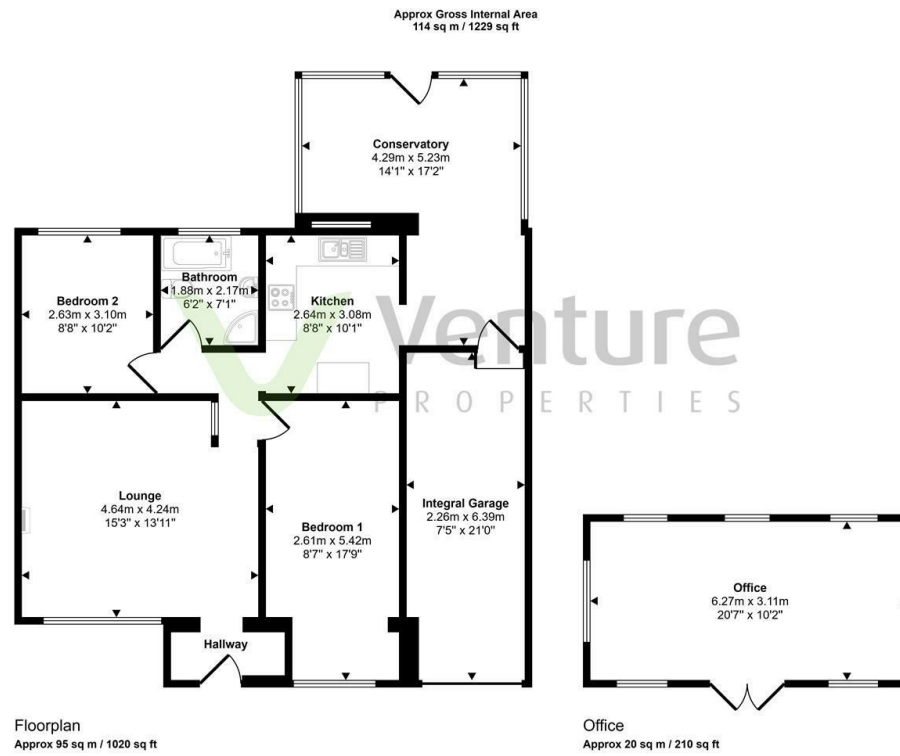

This floorplan is only for illustrative purposes and is not to scale. Measurements of rooms, doors, windows, and any items are approximate and no responsibility is taken for any error, omission or mis-statement. Icons of items such as bathroom suites are representations only and may not look like the real items. Made with Made Snappy 360.



Property Information

01325 363858

45 Duke Street, Darlington, County Durham, DL3 7SD
sales@venturepropertiesuk.com